

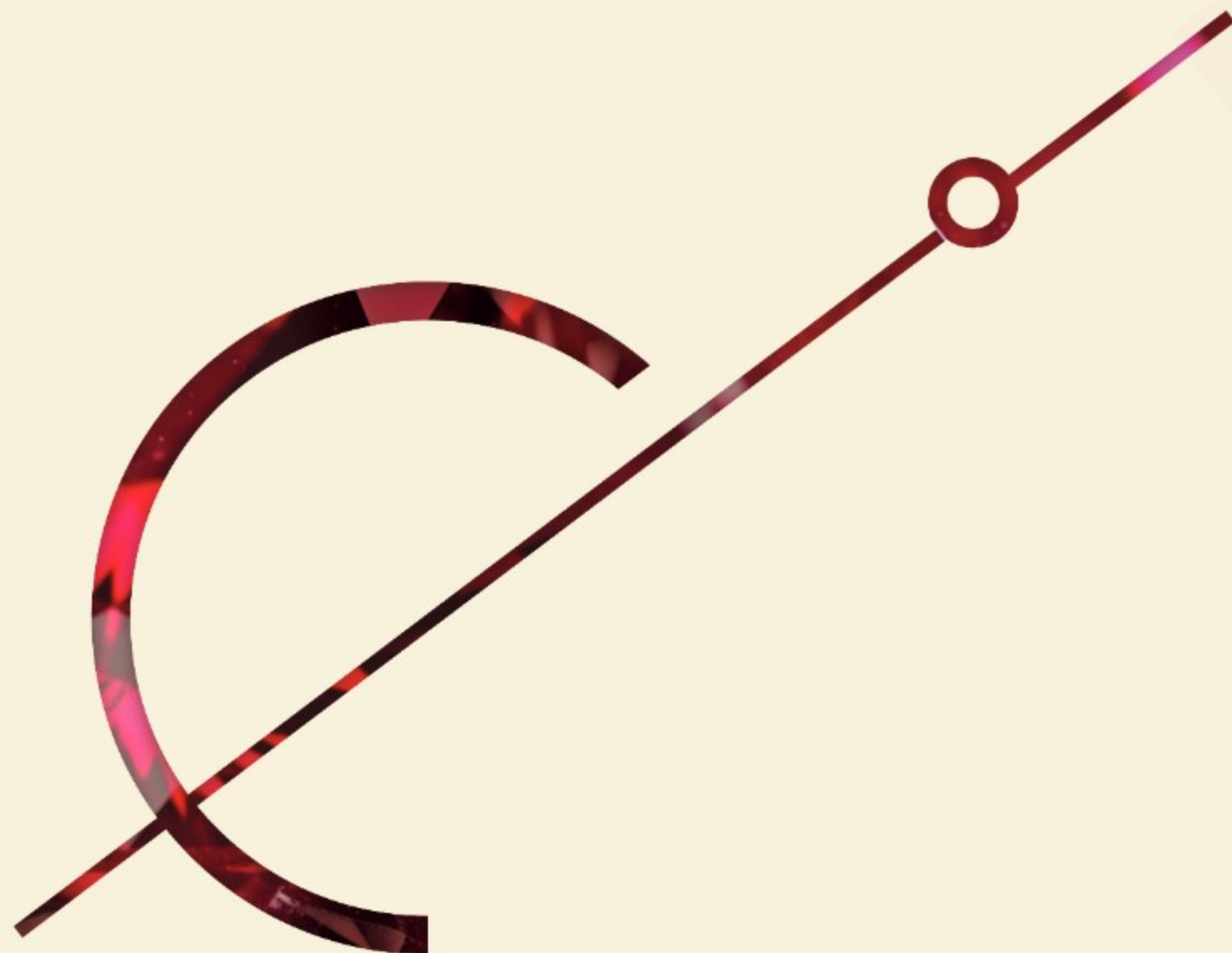

**M&M**  
**JACOB & CO**  
RESIDENCES  
— NOIDA —





# Inspired By The Impossible

Jacob & Co. is driven by an unyielding spirit of creativity and a relentless pursuit of the extraordinary. From his humble beginnings, founder Jacob Arabo has defied convention, transforming imagination into icons and ambition into artistry. Born in Tashkent and raised in Queens, New York, Jacob's fascination with design and time began early, guiding him from a jewellery apprentice to a visionary creator who would redefine luxury watchmaking and high jewellery. In 1986, he launched Jacob & Co., quickly establishing a reputation for bold, boundary-breaking creations that captured the world's attention. Jacob's journey has been marked by innovation and audacity. In 2002, he introduced the Five Time Zone watch. This vibrant, multi-time-zone masterpiece became a cultural touchstone and was embraced by global icons including Naomi Campbell, Bono and Derek Jeter. He went on to create horological marvels such as the Quenttin, the world's first vertical tourbillon with an unprecedented 31-day power reserve, and the celestial Astronomia Tourbillon, a rotating universe on the wrist that reimagined what a timepiece could be.

Over the decades, Jacob & Co. has collaborated with world-famous ambassadors, including Donnie Yen, Milla Jovovich and Cristiano Ronaldo, and introduced technically groundbreaking collections like the Epic SF24 and the Twin Turbo series. Across jewellery and watchmaking, Jacob's creations have stood at the intersection of innovation, craftsmanship and culture, coveted by celebrities, tastemakers and collectors worldwide. With each design, he continues to push the boundaries of what is possible, embodying a legacy of imagination made real.



Presence That  
Spans the Globe





A World Built  
by Jacob

Ras Al Khaimah, UAE



Stock Image

Business Bay, Dubai



Stock Image

AlJurf, Abu Dhabi



Stock Image

# Where rare vision meets Impossible Mastery

When two extraordinary forces meet, one defined by architectural brilliance and the other by the mastery of time, the result is nothing short of impossible. M3M, India's foremost name in luxury real estate, unites with Jacob & Co., the legendary maison of horology and haute craftsmanship, to craft a living experience unlike any the world has ever seen. This partnership transcends collaboration, it is the fusion of architecture and artistry, giving rise to a collectible landmark destined to redefine Indian luxury on a global stage.

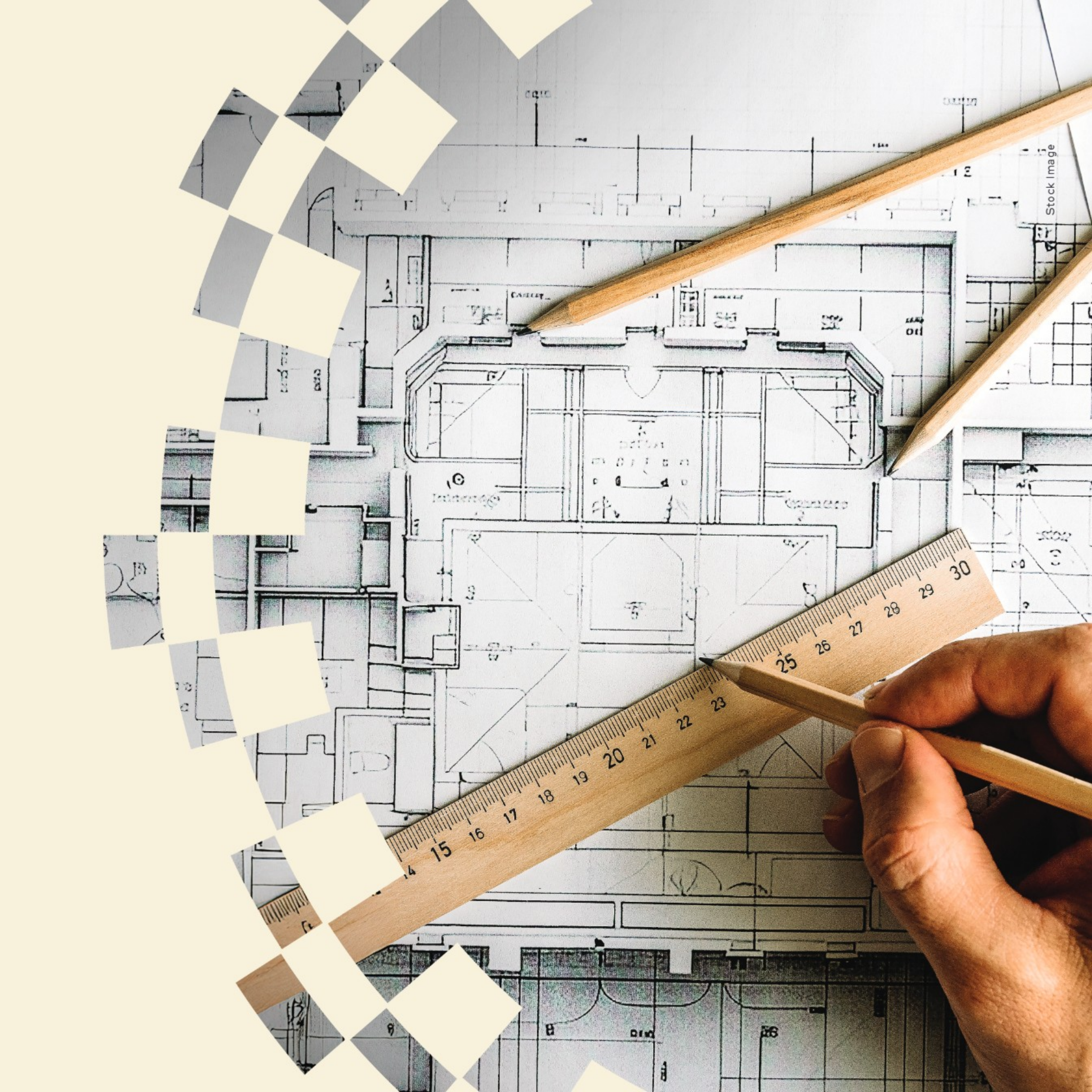



A Life Above The Ordinary

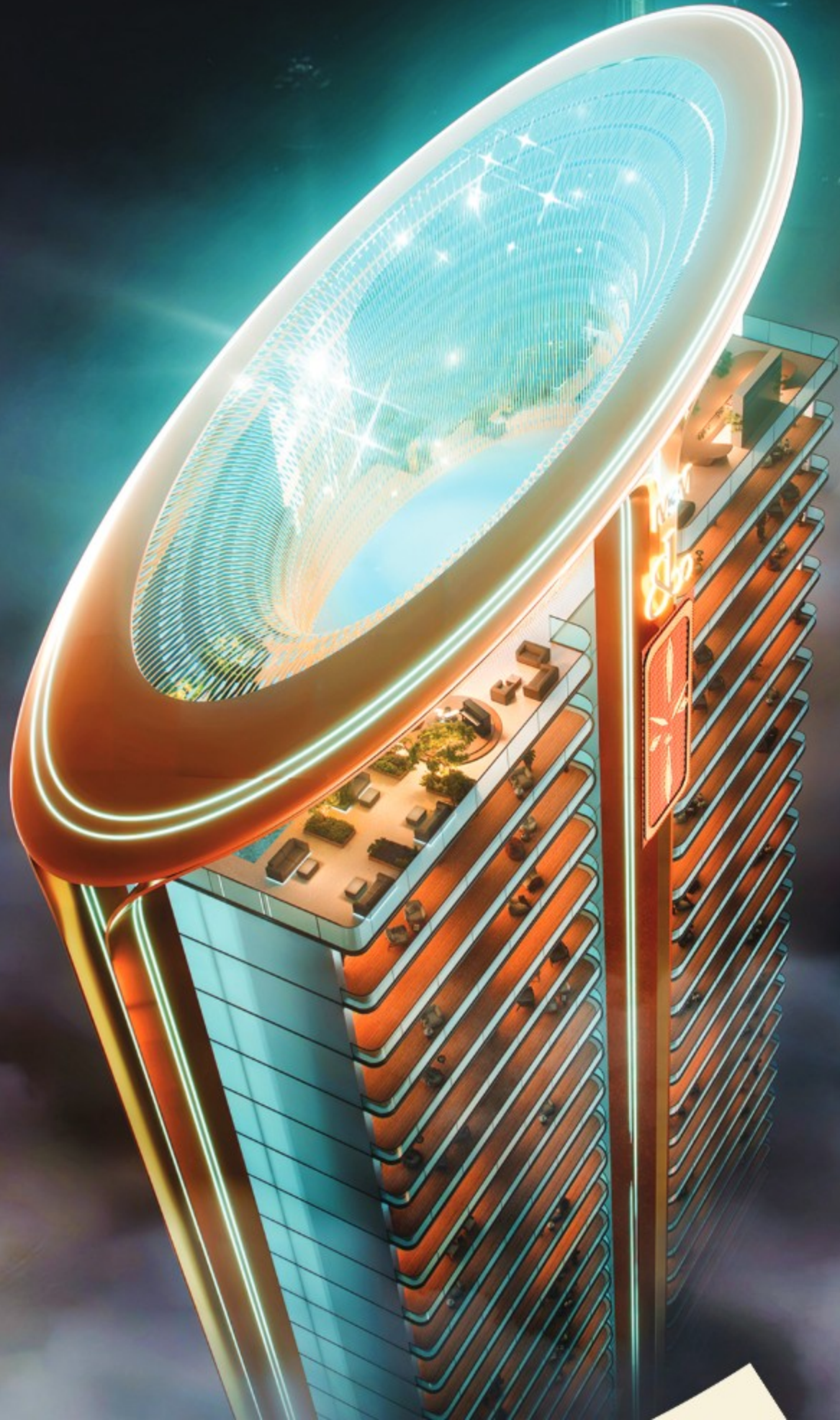



# Each Crown Of The Tower Celebrates A Distinct Indulgence

At the crown of M3M Jacob & Co. Residences lies a world reserved for the few, where elevation transcends altitude and becomes a way of living. Here, each sky lounge, infinity terrace, and private pavilion is imagined as an experience in itself, a realm of curated indulgence inspired by Jacob & Co.'s most exquisite creation.



# Living By The River Of Eternity

Here, the Yamuna becomes more than a view, it becomes your daily rhythm. An eternal presence that inspires calm, clarity, and a sense of belonging.

# Green Horizons At Your Doorstep

Experience mornings framed by acres of dew-kissed greens.  
A rare expanse of greens and fairways brings tranquility right  
to your window.



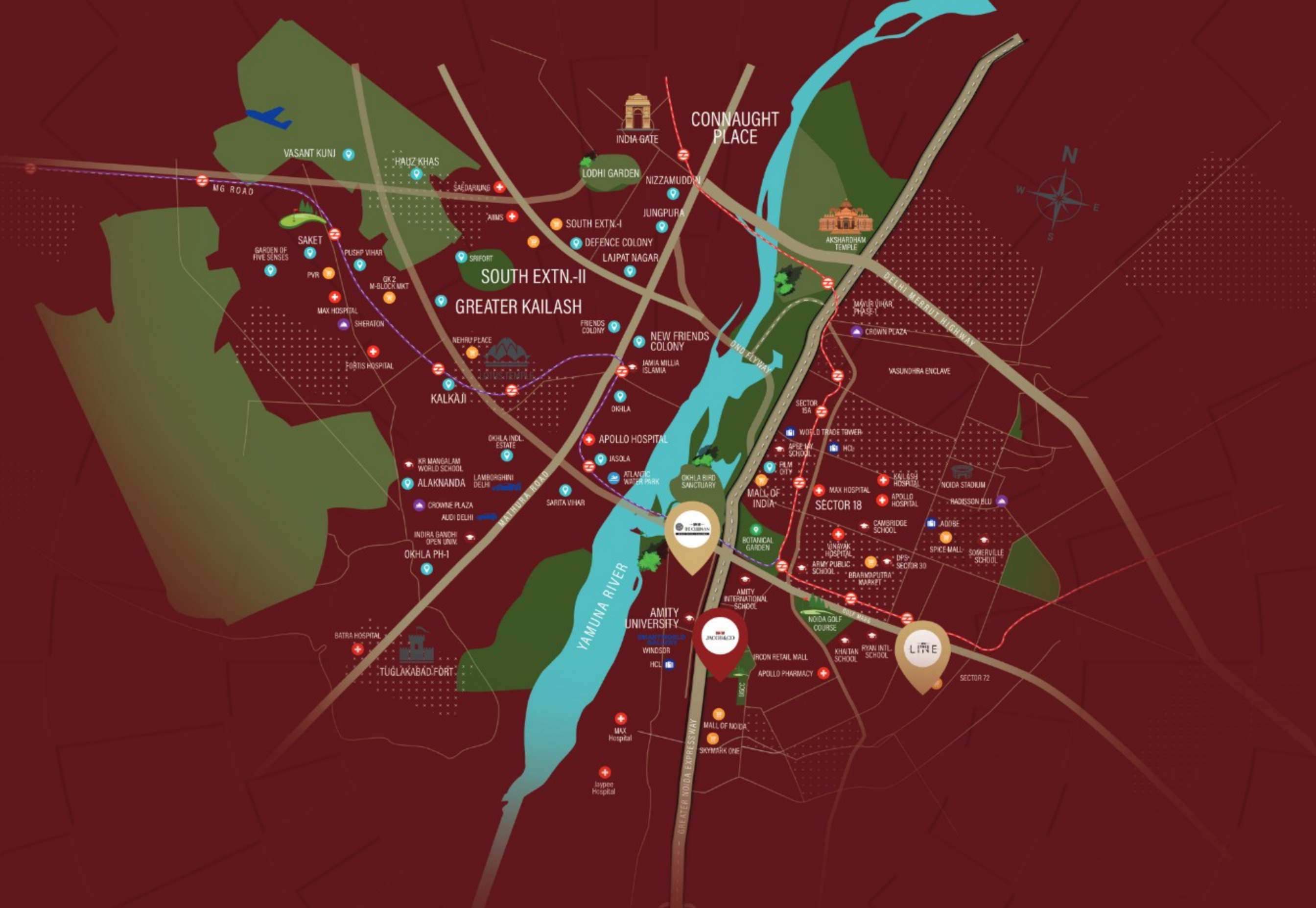

# An Icon Rises to Redefine The Skyline At Noida

## SCHOOLS & UNIVERSITIES

- Amity University – 2 min
- Pathways School – 5 min
- Cambridge School – 5 min
- Step By Step School – 8 min
- Genesis Global School – 10 min
- Shiv Nadar – 10 min

## HEALTHCARE

- Max Healthcare – 5 min
- Felix Hospitals – 8 min
- Jaypee Hospital – 8 min
- Apollo Hospital – 10 min
- Fortis Hospital – 10 min
- AIIMS, Delhi – 15 min

## CORPORATES

- Techno Park – 2 min
- Wipro – 5 min
- Jasola Business Park – 5 min
- Vatika Business Centre – 10 min
- LG Electronics India HO – 10 min
- NIIT – 15 min

## SHOPPING

- M3M Jewel Crest Avenue – 0 Min
- M3M The Cullinan Avenue – 5 min
- M3M The Line Avenue – 20 min
- Sector 18 – 15 min
- Logix City Center – 15 min
- Connaught Place – 35 min

## HOTELS

- Radisson Blu – 15 min
- Radisson Hotel – 20 min
- Crowne Plaza – 20 min
- Holiday Inn – 20 min



A Legacy  
To Be Collected



M&M  
& Co

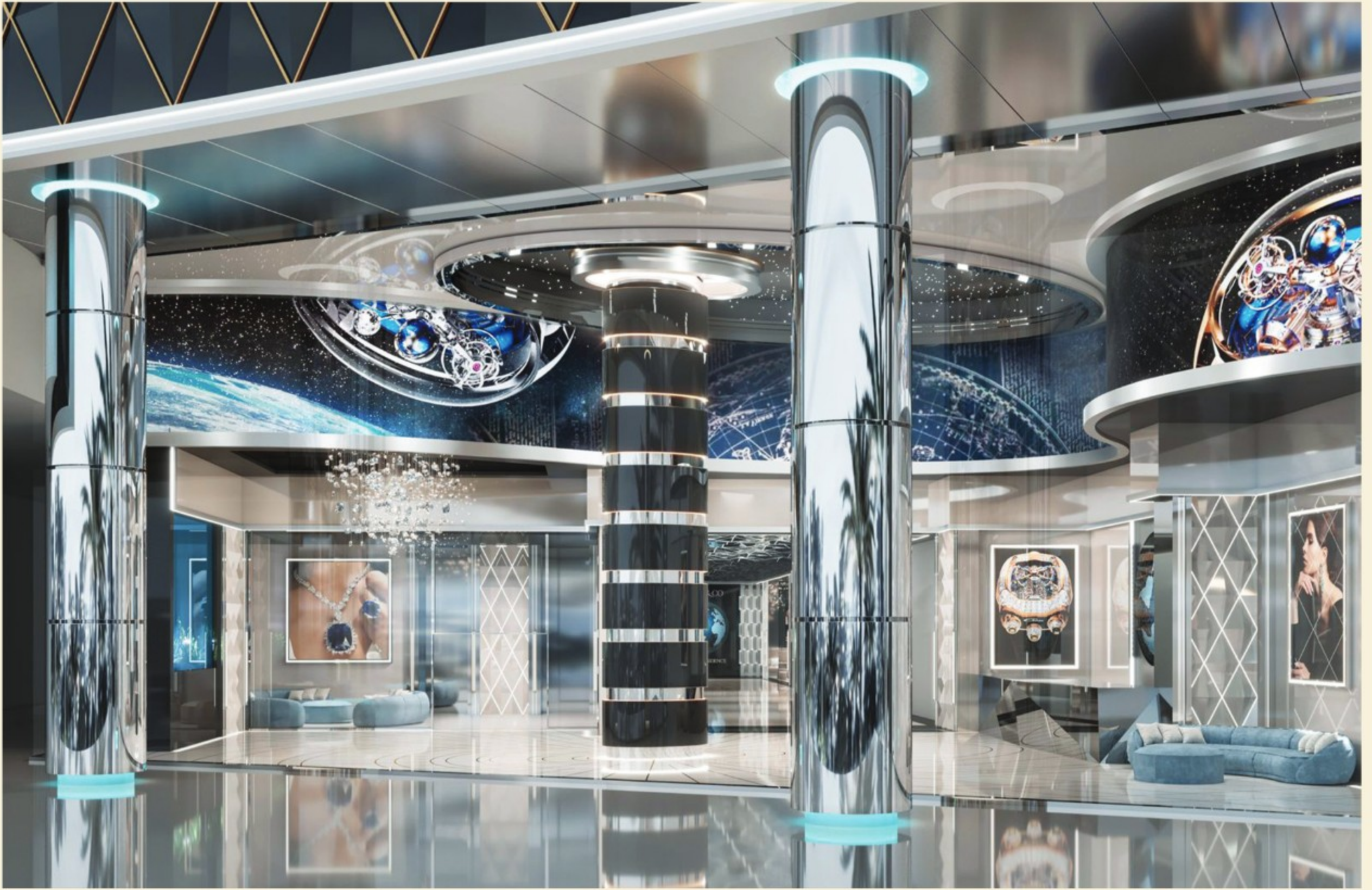

# Expansive Clubhouse

~50,000 sq. ft

An architectural jewel, hosting social, cultural, and lifestyle experiences crafted for global connoisseurs. Because true luxury is not owned. It's collected.



# Resort-Style Indulgence

Right At Your Doorstep

Artistic Impression





# An Oasis Designed For The Art Of Living Well

Artistic Impression





Whatever  
You Can Wish For

ENTRANCE LOBBY, WAITING AREA, **PRIVATE EVENT AREA WITH DINING BAR**, PRE-FUNCTION LOUNGE, **MULTIPURPOSE HALL** / BANQUET, OUTDOOR PARTY LAWN, **CLUB OFFICE**, **RESTAURANT (EUROPEAN KITCHEN, PAN ASIAN KITCHEN, CHEF STUDIO)**, **CAFÉ**, PRIVATE DINING ROOMS, BAKERY, **WINE LOUNGE** / BAR, **JUICE BAR**, ALFRESCO DINING, SPORTS LOUNGE, INDOOR GYM, **AEROBICS / PILATES STUDIO**, YOGA / MEDITATION ROOM, **BASKETBALL COURT**, SQUASH COURTS, TABLE TENNIS, GOLF SIMULATOR, PICKLE BALL, **PADEL COURT**, WALKING / JOGGING TRACK, OUTDOOR YOGA / MEDITATION AREA, OUTDOOR KIDS PLAY AREA, **ROCK CLIMBING WALL**, BADMINTON COURTS INDOOR, OUTDOOR POOL, KIDS POOL, KIDS PLAY POOL, **HEATED POOL**, LAP POOL, **PLUNGE POOL**, LAGOON POOL / BEACH POOL, JACUZZI, CHANGING ROOMS + SHOWERS, SPA, SALON, **SAUNA**, **STEAM**, SALT ROOM, TREATMENT ROOMS, HAMMAN SUITE, ICE ROOM, MUD AND CLAY THERAPY AREA SHOWERS, COUPLE TREATMENT ROOM / SPA

## 75+ AMENITIES

THERAPY ROOMS, **PHYSIO ROOM**, AMPHITHEATRE, GAZEBO / CABANAS SEATING, DECK SEATING, PETS PARK, VIEWING DECKS / **TERRACE SEATING**, CARDS ROOM / CHESS, KARAOKE LOUNGE, CIGAR LOUNGE, PRIVATE THEATRES, INDOOR KIDS PLAY AREA, LIBRARY + E-LIBRARY / READING ROOM, MUSIC ROOM, **ART STUDIO**, ROOF TOP LOUNGE / BAR, BOARD GAMES ROOM, POOL + BILLIARDS, **SENIOR CITIZENS LOUNGE**

Valet Services



Stock Image

Chef On Call



Stock Image

Maybach Services



Stock Image

# A World Without Limits

Living here is about indulgence without boundaries. Private lounges, sky-high experiences, wellness sanctuaries, curated concierge services, and entertainment spaces everything is designed for those who live at the highest echelons of luxury.



Stock Image

Round The Clock Butler



# Club & Recreational Amenities



Stock Image

Reading Lounge

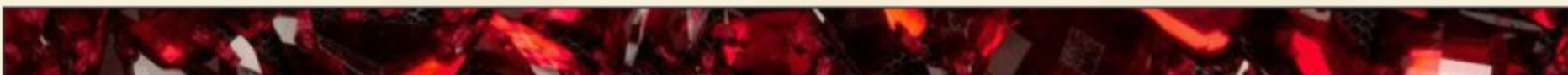

Pickle Ball



Stock Image

Alfresco Dining

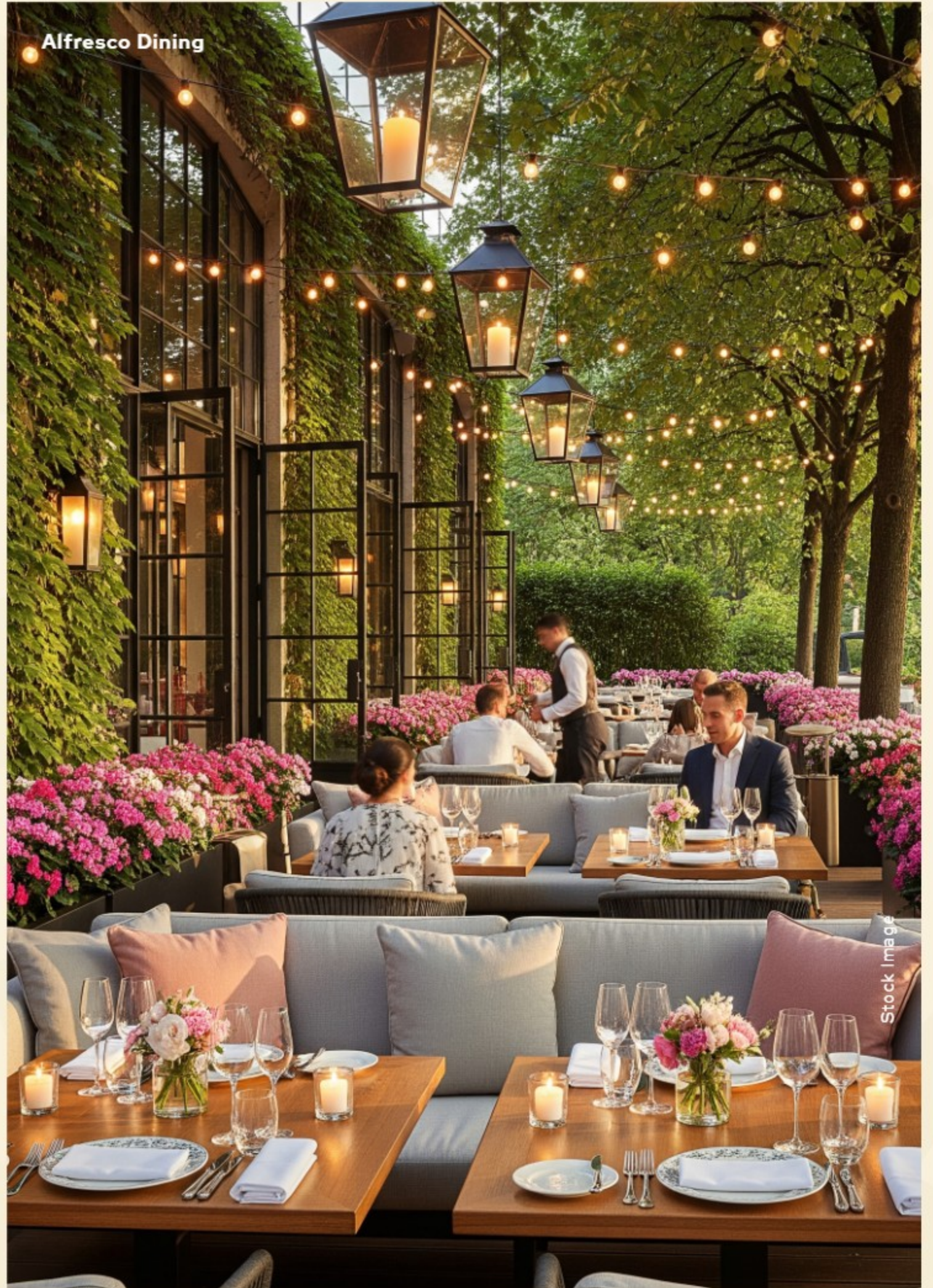

Stock Image



Pets Park



Stock Image



Rooftop Lounge

Stock Image



Heated Pool





Landscape & Wellness  
Amenities





The Residences

Artistic Impression





BILLIONAIRE  
4 Bed Residences



Artistic Impression



Artistic Impression



OPERA  
3 Bed Residences

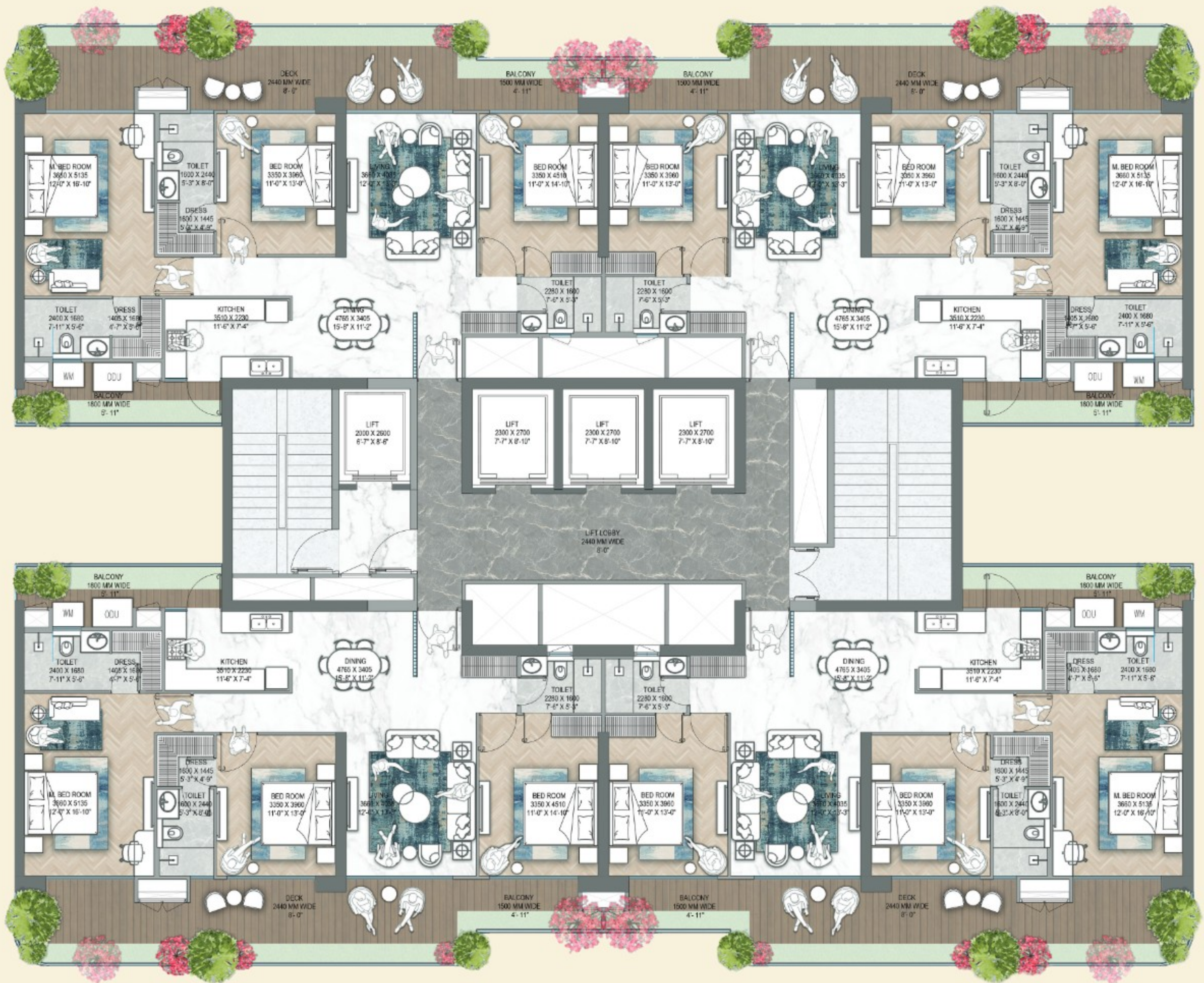



Stock Image

Where The  
Extraordinary  
Is Everyday



### MAGNIFICENCE IN THE TRINITY OF MEN, MATERIAL & MONEY

M3M is one of the fastest-growing real estate developers in the country with speed, class, luxury and innovation being at the core of its vision. The Group has launched a slew of iconic projects, designed and developed by world-class partners. "M3M X Jacob & Co. Residences being one of its most ambitious". The Group's projects have repeatedly been acknowledged as the best and have been felicitated with numerous business and lifestyle awards the world over. What sets M3M apart as a developer and provider of luxury living experiences across the country is its world-class designs, high-end amenities, and the use of top-notch materials. M3M has scripted its market success and built formidable brand equity within a short timespan owing to its firm commitment to innovation, quality, customer satisfaction, ethical behaviour and assured on-time deliveries.



A circular graphic with a grid of squares, resembling a globe or a map projection. The grid is composed of concentric circles and radial lines, creating a pattern of squares that vary in size and shape. The squares are arranged in a way that they appear to be part of a larger, curved surface. The text 'M3M' is centered in the middle of the circle.

**M3M**